

Godstowe



SPRING TERM 2022

www.godstowe.org

Headmistress

Ms Sophie Green

Deputy Heads

Academic and Organisation: Mr Charles Whitworth

Pastoral: Mrs Iliffe Kenyon

Head of Lodge

Mrs Claire Gillett

Head of Boarding

Mrs Michele Western-Kaye

Director of Learning and Teaching

Mr Paul Adams

Director of Upper School and Senior School Liaison

Mrs Fiona Reynolds

Deputy Head of Upper School

Miss Connie Bennett

Head of Lower School

Mrs Rebecca Rycroft

Deputy Head of Lower School

Mrs Hayley Humphries

Head of Early Years (Nursery and Beginners)

Miss Hannah Smart

Director of Admissions

Ms Nichola Beck

House Parents

Mrs Michele Western-Kaye and Mr Phillip Scriven

Mrs Emily Whitley

Ms Hayley McIlveen

Form Teachers

Early Years

Nursery Miss H Smart
Mrs L Gwiazda
Miss P Vejsholt
Miss M Vaughan
BG A Mrs R Adams
BG W Miss S Winnard

Lodge

KG A Mrs Z Archer
KG G Mrs K Gommo
TR H Mrs S Hutcherson
TR G Mrs C Gillett

Lower School

I H Mrs T Hornett
I C Mrs H Cox
I M Mrs A Moore
II H Mrs H Humphries
II S Mrs A Smith
II L Mrs J Lake
LIII L Mme C Labourdette
LIII D Mrs A Drury
LIII M Mrs Martin/Mrs Bennett
LIII H Miss P Hill

Upper School

MIII B Mrs N Baker
MIII E Mr S Emm
MIII L Mrs N Lee - Metcalfe
MIII C Miss C Bennett
UIII A Mrs A Agopian/
Mrs L A Kane
UIII L Mrs R Lake
UIII S Mrs M Scragg
IV A Mrs K Abbi
IV P Mrs A Pana
IV V Ms L de Villiers

All email addresses (except for housemistresses):
initial+surname+@igodstowe.org eg jblake@igodstowe.org

Godstowe Preparatory School

Shrubbery Road, High Wycombe, Buckinghamshire HP13 6PR.

Tel: +44 (0)1494 529273

www.godstowe.org

Contacts:

Reception	reception@godstowe.org	01494 529273
School Office	schooloffice@godstowe.org	01494 529273
Headmistress	headmistress@igodstowe.org	01494 429011
Deputy Head (Ac. & Org.)	cwhitworth@igodstowe.org	01494 429023
Deputy Head (Pastoral)	ikenyon@igodstowe.org	01494 429019
Head of Boarding	headofboarding@igodstowe.org	01494 429014
Admissions	registrar@godstowe.org	01494 529273
Finance Director	bursar@godstowe.org	01494 429000
Head of Lodge	cgillett@igodstowe.org	01494 429012
Lodge Office	sarmstrong@igodstowe.org	01494 429012
Nursery	nursery@igodstowe.org	01494 429013
Highlands House	highlands@igodstowe.org	01494 523297
Turner House	turner@igodstowe.org	01494 429014
Walker House	walker@igodstowe.org	01494 429010
Sick Bay	sister@igodstowe.org	01494 429002
Uniform Shop	uniformshop@godstowe.org	01494 429005
2nd Hand Uniform Shop	gsfogshus@gmail.com	
Friends of Godstowe	friends@igodstowe.org	

The Godstowe Preparatory School Limited. Registered in England number 68471. Charity number 310637

Monday, 3rd January

Tuesday, 4th January

INSET

Wednesday, 5th January

	INSET
2-4pm	Uniform Shop open
3-5pm	Term begins for existing boarders
4-5pm	Term begins for new boarders
5.30pm	Boarders supper and Ms Green's welcome back

Thursday, 6th January

8.15am	Term begins for Lodge and Nursery pupils
8.25am	Term begins for day pupils
	Cheltenham Ladies College entrance exams at Godstowe
	No clubs but supervised prep available in Main School until 6.30pm and aftercare available in Lodge until 5.25pm

Friday, 7th January

Cheltenham Ladies College entrance exams at Godstowe
No clubs but supervised prep available in Main School until 6.30pm and aftercare available in Lodge until 5.25pm

Saturday, 8th January

Boarders: Fun with Friends Activities and the 'Big Film'

Sunday, 9th January

Boarders trip: Glorious Guildford

Monday, 10th January

Start of the Spring Term Enrichment Curriculum in Lodge and Main School

Tuesday, 11th January

Lower and Upper School Assemblies

Wednesday, 12th January

Thursday, 13th January

Deadline for applications for 11+ Godstowe Scholarship

Friday, 14th January

“Le Fete des Rois” celebrations in Lodge and Main School
Boarders: Horse riding

Saturday, 15th January

Boarders: Cinema trip
10-12.30pm USA Lacrosse Squad training (home)
2-4pm U11A High 5 Netball Tournament at Hall Grove (arrive 13:15)

Sunday, 16th January

Boarders: Clip and Climb trip

Monday, 17th January

11+ Common Entrance exams at Godstowe

Tuesday, 18th January

6pm Whole School Assembly
11+ Common Entrance exams at Godstowe
Senior Schools Information Evening for FI, FII, LIII and MIII parents

Wednesday, 19th January

2.40pm 13+ Wycombe Abbey entrance exams at Wycombe Abbey
4.30pm U11A-C 5 a side Netball v Chesham Prep (home)
4.45pm U12A-D Netball Wycombe Abbey (away)
U13A-D Netball Wycombe Abbey (home)

Thursday, 20th January

13+ Wycombe Abbey entrance exams at Wycombe Abbey (morning only)
13+ Downe House Scholarship exams at Godstowe (afternoon only)

Friday, 21st January

13+ Downe House Scholarship exams at Godstowe
Lowers Parents’ Evening and Senior Schools Exhibition
EXEAT - All pupils should leave by 4.10.
Please see staggered collection times found on page 19.
No after-school clubs for Main School or Lodge.
Supervised prep available in Main School until 5.30pm.
Aftercare available in Lodge until 5.25pm.
Boarders: escorted train service to London Marylebone available

Saturday, 22nd January

U8-U11 Cross Country at Lowndes Park - am (away)

Sunday, 23rd January

6-7pm Boarders return (no supper provided)

Monday, 24th January

13+ Spring Common Entrance exams at Godstowe
 11+ Godstowe Scholarship exams week
 4.30pm Netball U11A v High March (away)

Tuesday, 25th January

Colour Team Assemblies
 13+ Spring Common Entrance exams at Godstowe
 Perform! Workshops for Lodge and Nursery in the Sports Hall Gallery

Wednesday, 26th January

13+ Spring Common Entrance exams at Godstowe
 5.15-7.30pm U12/U13 Swimming at Wycombe Abbey invitational (away) tbc
 4.00pm U9, U10, U11 Division 10 Swimming Gala at St. Helen's Time tbc

Thursday, 27th January

4:30pm U13 A- B Netball v Stowe (home) tbc

Friday, 28th January

Perform! Workshops for Lodge and Nursery in the Sports Hall Gallery
 Boarders: Horse riding

Saturday, 29th January

Boarders: Bake Off Challenge
 9.00am start U10 Netball Tournament at St George's, Ascot
 9.30am start U13A-D Netball at St Albans High School
 9.30am start U12A Lacrosse at St Albans High School
 10.30am start U12A-D Netball at St Albans High School
 10.30am start U13A Lacrosse at St Albans High School

Sunday, 30th January

Boarders: Rush trip

Monday, 31st January

Tuesday, 1st February

Lower and Upper School Assemblies

Wednesday, 2nd February

4.15pm U13A Lacrosse v Stowe (home) tbc
 U11-U13 Cross-country Buckinghamshire Schools' Championship at Stowe (away) - time tbc

Thursday, 3rd February

Friday, 4th February

All day U13A Netball IAPS regional tournaments at Uppingham (away)
 All day U11A Netball IAPS regional tournament at St George's Ascot (away)
Boarders: Horse riding

Saturday, 5th February

Chinese New Year Craft and Cooking
 U8-U11 Cross-country at Hughenden Park (away) - am time tbc
 10.30am U12A, U13A Lacrosse v Haileybury (away)
 10.30am U12A, U13A Netball Masterclass at Haileybury (away)

Sunday, 6th February

Chinese New Year Feast and Festivities

Monday, 7th February

Revision week for Fourth's
Cheltenham Ladies College Scholarship assessments (by invitation)
4.15pm U9 2 teams Netball v Heatherton House (home)

Tuesday, 8th February

Whole School Assembly
Revision week for Fourth's
4.15pm U10 3 Teams Netball v High March (home)

Wednesday, 9th February

Open Morning (Lodge)
Revision week for Fourth's
ISEB Pretests for Headington at Godstowe
3pm U11 A-D Netball at Lambrook & (St. Pirans) (away)
4.10-6pm U12/U13 Swimming at Wycombe Abbey (League) (away)

Thursday, 10th February

Open Morning (Main School)
Revision week for Fourth's

Friday, 11th February

Revision week for Fourth's
ISEB Pretests for Headington at Godstowe
4.30pm Student Recital, RH
Boarders: Horse riding

Saturday, 12th February

Boarders: Weekend Revision and Mindfulness and Relaxation Workshop
9.30-12.30am USA Lacrosse Squad Training with England players (home)

Sunday, 13th February

Boarders: Weekend Revision and Yoga Workshop

Monday, 14th February

Mock Examination week for Fourth's

Tuesday, 15th February

Mock Examination week for Fourth's
Lower and Upper School Assemblies
Transition visit to All Saints' Parish Church, High Wycombe

Wednesday, 16th February

Mock Examination week for Fourth's
4.15pm U9 3 teams Netball v High March (home)

Thursday, 17th February

Mock Examination week for Fourth's

Friday, 18th February

**HALF TERM - All pupils should leave by 4.10pm.
Please find staggered collection times found on page 19.**

No after-school clubs for Main School or Lodge.
Supervised prep available in Main School until 5.30pm.
Aftercare available in Lodge until 5.25pm.
Boarders: escorted train service to London Marylebone available

Saturday, 19th February

HALF TERM

Sunday, 20th February

HALF TERM

Monday, 21st February

HALF TERM

Tuesday, 22nd February

HALF TERM

Rugby Academic Scholarship exams at Rugby School

Wednesday, 23rd February

HALF TERM

Rugby Academic Scholarship exams at Rugby School

Thursday, 24th February

HALF TERM

Friday, 25th February

HALF TERM

Saturday, 26th February

HALF TERM

Sunday, 27th February

6-7pm Boarders return (no supper provided)

Monday, 28th February

Tuesday, 1st March

Lower and Upper School Assemblies
Marlborough College Academic Scholarship at Godstowe

Wednesday, 2nd March

12.45-5pm U10A (5-a-side) Netball v St Edward's Oxford (away)
4.15pm U12 A&B Netball v Bishopsgate (home) tbc

Thursday, 3rd March

Activities Day (Main School)
World Book Day

Friday, 4th March

4.30pm Student Recital, RH
Marlborough College Academic Scholarship at Godstowe
Boarders: Horse riding

Saturday, 5th March

Boarders: House activities

Sunday, 6th March

Boarders: Kidzania trip

Monday, 7th March

Careers week (details to follow)
 4.15pm U11 3 teams Netball v High March (home)

Tuesday, 8th March

Careers week (details to follow)
 Whole School Assembly
 Lodge Parents' Evenings by appointment
 U9, U10, U11 Diving 10 Swimming Gala at St Helen's, time tbc
 4.15pm U13 C Netball District Tournament at Great Marlow (away)

Wednesday, 9th March

Careers week (details to follow)
 Lodge Parents' Evenings by appointment
 U12/U13 Swimming at Wycombe Abbey (League Final if qualify) time tbc

Thursday, 10th March

Careers week (details to follow)

Friday, 11th March

Careers week (details to follow)
 Uppers Parents' Evening
EXEAT - All pupils should leave at 4.10.
Staggered collection times can be found on page 19.
 No after-school clubs for Main School or Lodge.
 Supervised prep available in Main School until 5.30pm,
 Aftercare available in Lodge until 5.25pm.
 Boarders: escorted train service to London Marylebone available

Saturday, 12th March

10.00-12.00pm U10A High-5 Netball Tournament at Hall Grove (away)
 10.00-12.00pm U9A High-5 Netball Tournament at Hall Grove (away)

Sunday, 13th March

6-7pm Boarders return (no supper provided)

Monday, 14th March

All day U13A Netball IAPS National Finals (if qualify) (away)

Tuesday, 15th March

Colour Team Assemblies
 FI & FII Parents' Evening

Wednesday, 16th March

1.45pm Lodge Interactive Theatre Experience, Sports Hall Gallery
 All day U12A IAPS National Finals (no regional event) at Rugby School (away)
 4.30pm U13A&B, U12B Netball District Tournaments at Wycombe Abbey (away)

Thursday, 17th March

7pm Loweres Production
 4.15pm U12C Netball District 'B' Tournament at St. Michael's (away)

Friday, 18th March

7pm Loweres Production
 All day U11 IAPS National Finals (if qualify) at Bryanston School, (away)
 Boarders: Horse riding

Saturday, 19th March

Boarders: Mothering Sunday Craft Workshop

Sunday, 20th March

Boarders: Science Museum trip (tbc)

Monday, 21st March

4.30pm U8, U9, U10, U11 Swimming v Lambrook (home)

Tuesday, 22nd March

3.15pm Lower and Upper School Assemblies
 U13 Lacrosse Nationals Schools Tournament at Aldershot (away) all day
 U9 Netball v Pipers Corner (home)

Wednesday, 23rd March

ABRSM practical and theory exams

Thursday, 24th March

2pm ABRSM practical and theory exams
 U11 U12 U13 Swimming IAPS Regional Round at Crosfields School, (away)

Friday, 25th March

2.15pm Last day of Spring Term Enrichment Curriculum, Lodge and Main School
 ABRSM practical and theory exams
 U10 Netball Tournament at Pipers Corner (away) tbc

Saturday, 26th March

Boarders: Packing and the 'Big Film'

Sunday, 27th March

Boarders: Easter Egg Scavenger Hunt

Monday, 28th March

Lodge Art Day

Tuesday, 29th March

11.30am Lodge Easter Bonnet Parade for all Lodge and Nursery children
 12.30pm Lodge Perriss Knight Awards, Recital Hall
 2.15pm Lodge End of Term (no aftercare)
 End of Term Concert, JK Theatre

Term ends for Main School, all pupils to leave by 4.10pm.
 Staggered collection times as follows:
 3.40pm Boarders to depart
 3.55pm Lower School pupils to depart (and older siblings from Reception)
 4.10pm Upper School pupils to depart
 No after-school clubs for Main School or Lodge.
 Supervised prep available in Main School until 5.30pm.
 No Boarders escorted train service

USA Lacrosse tour 2022 - Wednesday 30th March, returning Monday 11th April

The Summer Term starts on Sunday 24th April 2022 for boarders and Monday 25th April for Lodge and Main School day pupils.

Uniform Shop Opening Times:

Tel: 01494 429005 during opening hours only (please do not leave a message)

uniformshop@godstowe.org

During Term Time: Please email to arrange an appointment

Monday 1pm – 5pm

Friday 8am – 12 noon

Prior to Beginning of Term:

Wednesday 5th January, 2-4pm or alternatively shop online at www.directclothing.co.uk

Second Hand Uniform Shop:

gsfogshus@gmail.com

During Term Time:

Monday 8.30am – 9.15am

Friday 3.30pm – 4.30pm

Summer Term 2022

Sunday 24 April

Monday 25 April

Friday 29 April – Monday 2 May

Friday 27 May – Sunday 5 June

Friday 17 – Sunday 19 June

Tuesday 5 July

Term begins for boarders

Term begins for day pupils

LONG EXEAT

HALF TERM

EXEAT

Term ends (time to be advised)

Autumn Term 2022 (provisional)

Monday 5 September

Tuesday 6 September

Friday 23 – Sunday 25 September

Wednesday 19 - Sunday 30 October

Friday 18 – Sunday 20 November

Friday 9 December

Term begins for boarders (afternoon return)

Term begins for Lodge and Nursery pupils

Term begins for Main School day pupils

LONG EXEAT

HALF TERM

EXEAT

Term ends (time to be advised)

Exeat and Half Term collection times

All pupils to leave by 4.10pm

Lodge and Nursery

3.15pm

Nursery pupils to depart

3.25pm

Beginners pupils to depart

3.35pm

Kindergarten pupils to depart

3.45pm

Transition pupils to depart

Main School

3.40pm

Boarders to depart

3.55pm

Lower School pupils to depart
(and older siblings from reception)

4.10pm

Upper School pupils to depart

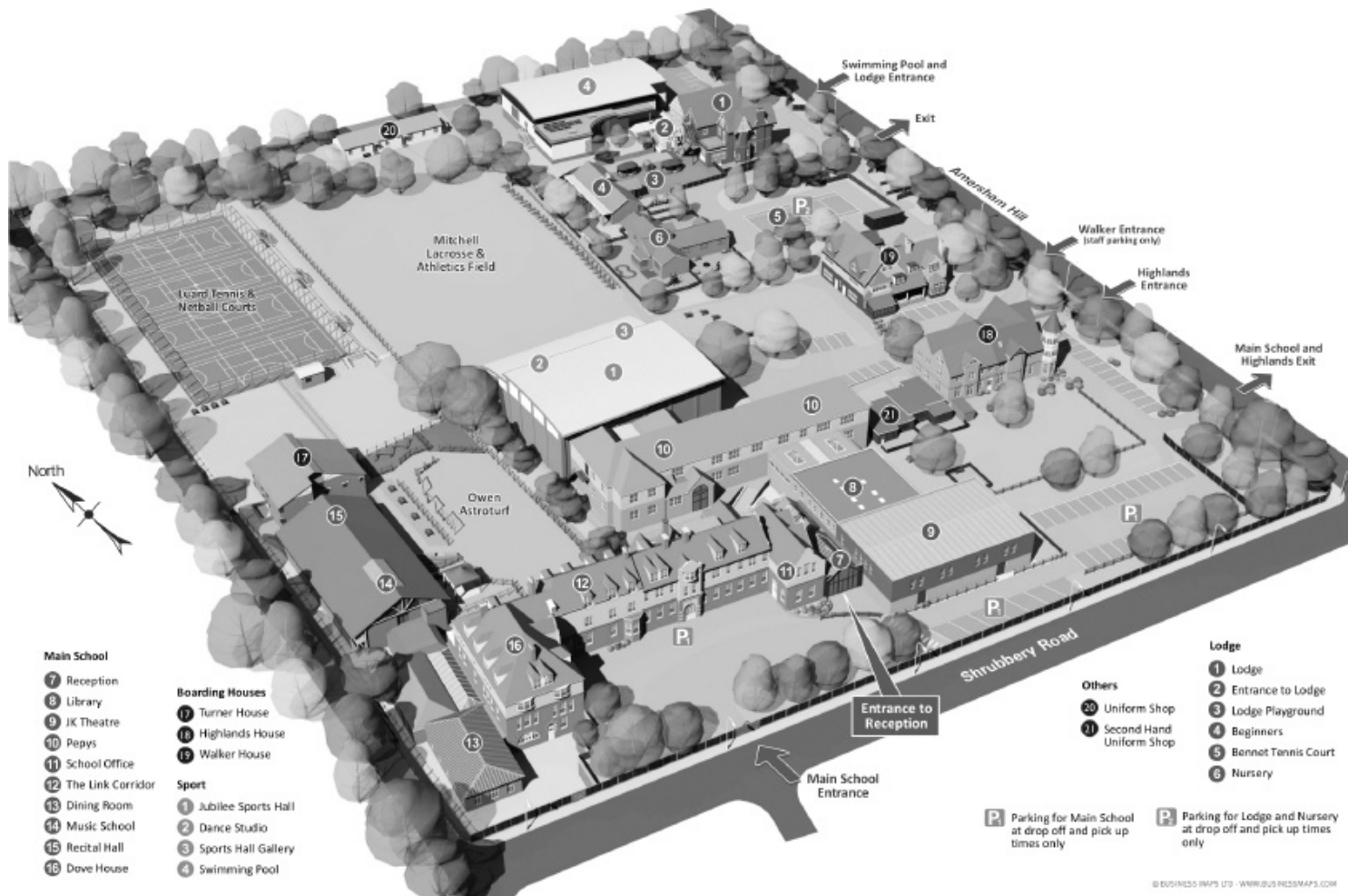

Main School

- 7 Reception
- 8 Library
- 9 JK Theatre
- 10 Pepys
- 11 School Office
- 12 The Link Corridor
- 13 Dining Room
- 14 Music School
- 15 Recital Hall
- 16 Dove House

Boarding Houses

- 17 Turner House
- 18 Highlands House
- 19 Walker House

Sport

- 1 Jubilee Sports Hall
- 2 Dance Studio
- 3 Sports Hall Gallery
- 4 Swimming Pool

Lodge

- 1 Lodge
- 2 Entrance to Lodge
- 3 Lodge Playground
- 4 Beginners
- 5 Bennet Tennis Court
- 6 Nursery

Others

- 20 Uniform Shop
- 21 Second Hand Uniform Shop

P Parking for Main School at drop off and pick up times only

P Parking for Lodge and Nursery at drop off and pick up times only

All information correct at time of publication. For any amendments, please go to

www.godstowe.org